

THE LEICESTERSHIRE COUNTY COUNCIL  
(VARIOUS ROADS, BURBAGE, HINCKLEY AND BARWELL  
(BOROUGH OF HINCKLEY AND BOSWORTH)  
PROHIBITIONS OF VEHICULAR MOVEMENTS) (IN PART) ORDER 2016

The Leicestershire County Council ("the Council") in exercise of its powers under Sections 1 (1) , 2 (1) 2 (2) 4 5 and Part IV of Schedule 9 of the Road Traffic Regulations Act 1984 ("the Act") and of all other enabling powers and after consultation with the chief officer of police in accordance with Part III of Schedule 9 to the Act and Regulation 23 of the Local Authorities Traffic Order (Procedure) England and Wales Regulations 1996, hereby makes the following Order:-

1. This Order may be cited as "The Leicestershire County Council (Various Roads, Burbage, Hinckley and Barwell (Borough of Hinckley and Bosworth) Prohibitions of Vehicular Movements) (In Part) Order 2016
2. The Order shall come into force on the twenty fifth day of January 2016
3. The Orders specified in Schedule 1 to this Order are hereby revoked
3. No person, except upon the direction or with the permission of a police officer or a community support officer, shall cause or permit any motor vehicle to proceed along that length of road as specified in Schedule 2 to this Order, except for the purpose of access.
4. No person shall, except upon the direction or with the permission of a police officer in uniform, or a community support officer, shall cause or permit any vehicle to enter the road specified in Schedule 3 to this Order.

- 5 The plans annexed to this Order and marked drawing numbers 4225.000/Z1/1/2A, TM4276/1/2014, TM4273/1/2014 4225.000/Z1/1/1A are for identification purposes only.

**SCHEDULE 1**  
**REVOCATIONS**

**Items to be revoked from:**

**THE BOROUGH COUNCIL OF HINCKLEY AND BOSWORTH (PROHIBITION OF ENTRY FOR MOTOR VEHICLES - COTES ROAD BURBAGE) TRAFFIC REGULATION ORDER 1986**

**No entry for motor vehicles**

**Cotes Road, Burbage**

from a point 90 metres from the junction with Coventry Road to Sketchley Road in a northerly direction with an exception for access to premises and land adjacent to this length of road

SCHEDULE 2

**Imposition of  
Prohibition of Driving of All Motor Vehicles**

**Cotes Road, Burbage**

from its junction with Sketchley Road to its junction with Coventry Road







THE COMMON SEAL of THE LEICESTERSHIRE )  
COUNTY COUNCIL was hereunto affixed )  
This nineteenth day of January 2016 )  
in the presence of :- )

32313 (a)



*Ulmer Hasler*

# BARWELL

- KEY**
-  Proposed footway buildout
  -  Proposed scheme included as part of neighbouring consultations. See drawings 4225.000.Z1/1/2A & 4225.000.Z1/1/3A
  -  Proposed no waiting at any time (double yellow lines)
  -  Proposed limited waiting 1hr Mon - Sat 8am - 6pm no return for 1hr
  -  Existing limited waiting to be revoked and changed to unrestricted parking
  -  Proposed one way system

**DISCLAIMER:**  
 OTHER RESTRICTIONS NOT SHOWN ON THIS PLAN ARE NOT PART OF THE PROPOSED SCHEME AND THEREFORE WILL NOT CHANGE  
 THIS PLAN IS FOR GRAPHICAL REPRESENTATION ONLY AND DOES NOT FORM PART OF THE FINAL LEGAL ORDER



ENVIRONMENT AND TRANSPORT DEPARTMENT 

PHIL CROSSLAND  
DIRECTOR

TRAFFIC & SAFETY GROUP

TRAFFIC MANAGEMENT

TITLE:  
**BARWELL:**  
**PROPOSED ONE WAY SYSTEM AND PARKING CONTROLS**

DRAWING NUMBER	SCALE
TM4276/1/2014	NTS
PREPARED BY: R DAVIES	DATE: OCT 2014
CHECKED BY: M PALFREYMAN	SIZE: A3
APPROVED BY: M PALFREYMAN	CORR. FILE:

COUNTY HALL \* GLENFIELD \* LEICESTER \* LE3 8ST  
 Tel: 01163 050001 \* Fax: 0116 3050006  
 E-Mail address: [customerservices@leics.gov.uk](mailto:customerservices@leics.gov.uk) [www.leics.gov.uk](http://www.leics.gov.uk)

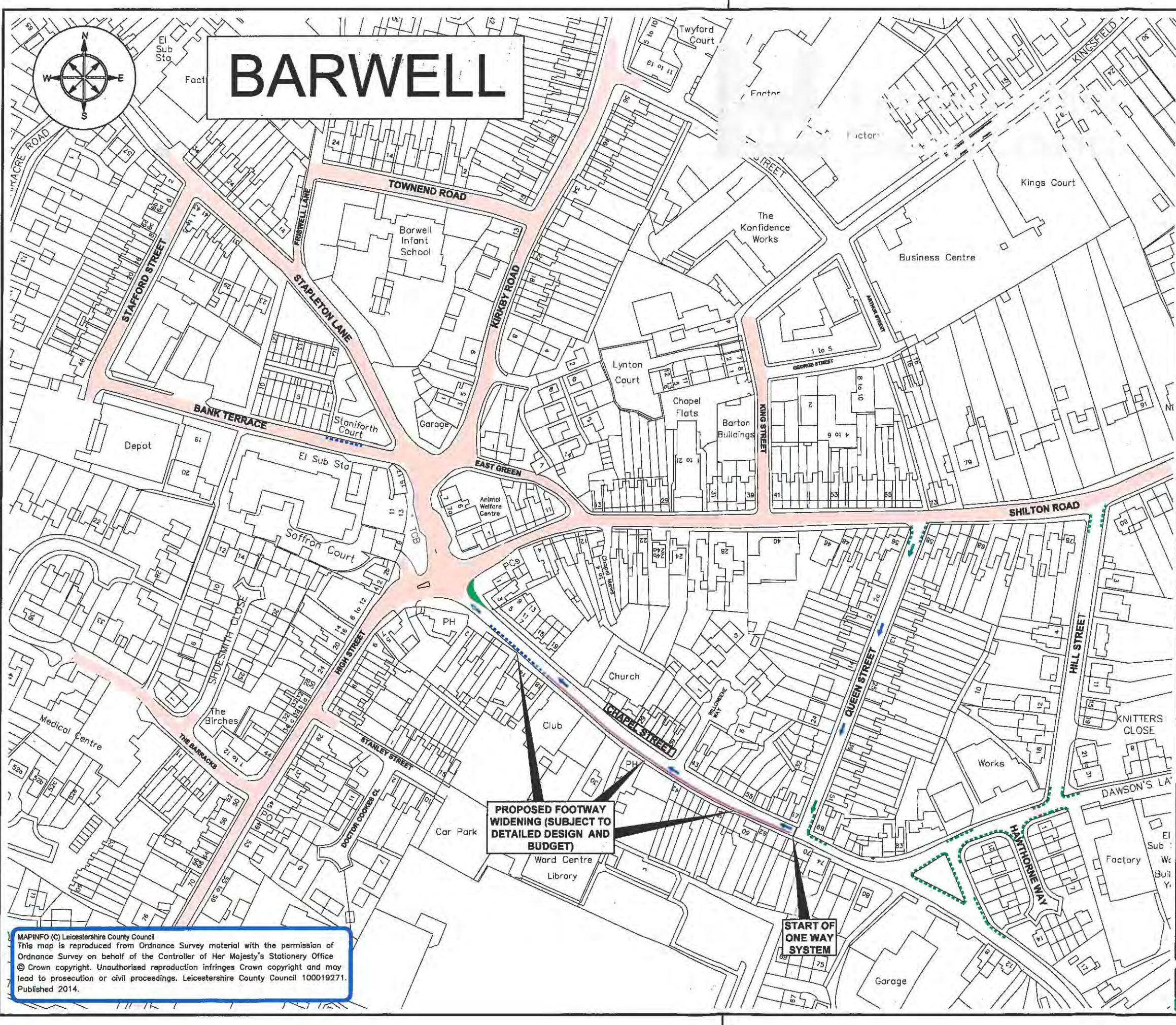

**PROPOSED FOOTWAY WIDENING (SUBJECT TO DETAILED DESIGN AND BUDGET)**

**START OF ONE WAY SYSTEM**

MAPINFO (C) Leicestershire County Council  
 This map is reproduced from Ordnance Survey material with the permission of Ordnance Survey on behalf of the Controller of Her Majesty's Stationery Office © Crown copyright. Unauthorised reproduction infringes Crown copyright and may lead to prosecution or civil proceedings. Leicestershire County Council 100019271. Published 2014.

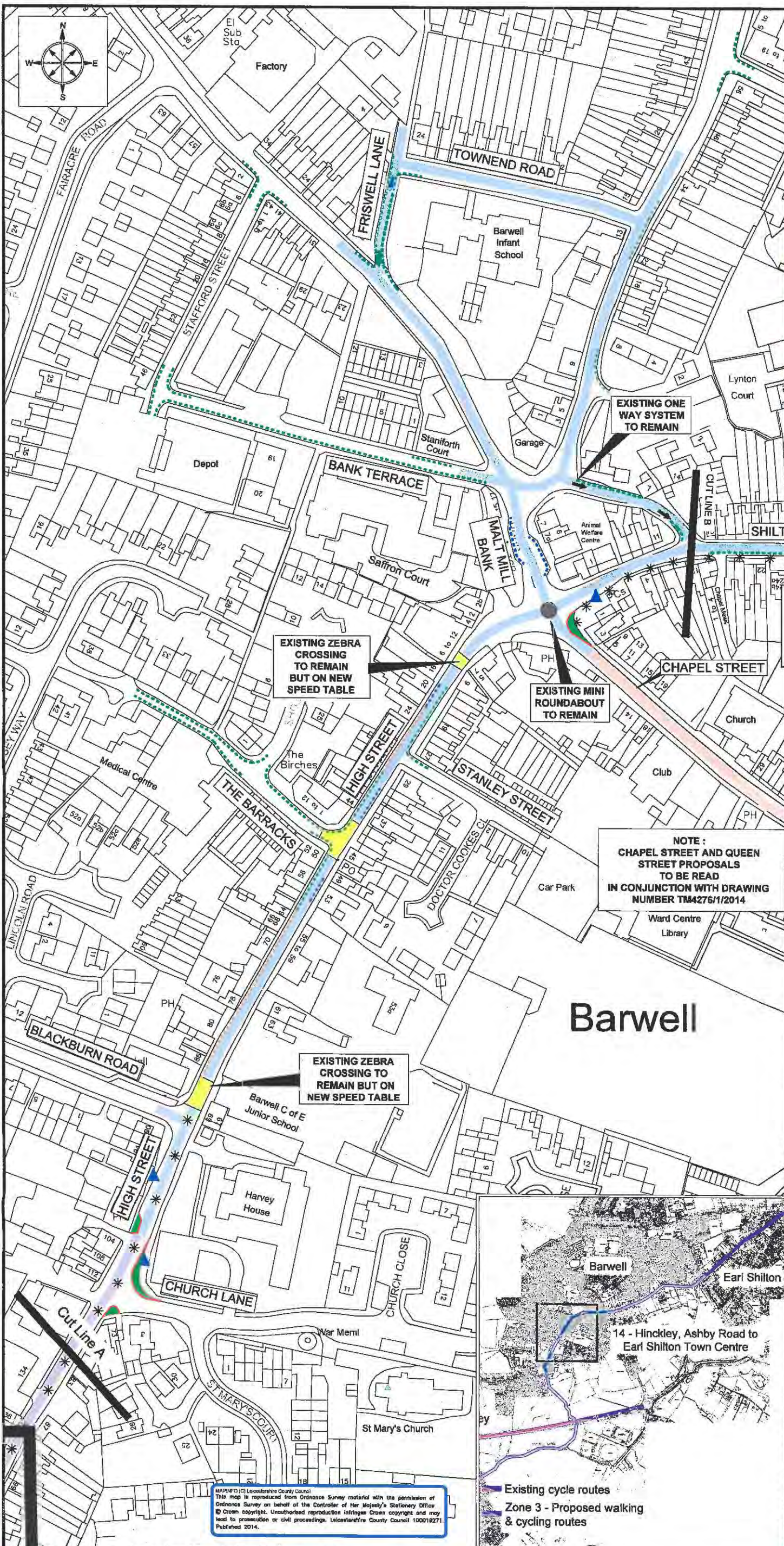

- NOTES:**
- KEY:**
- Proposed on-carriageway section of cycle route, with cycle symbols as needed
  - Proposed on-carriageway section of cycle route within proposed 20mph speed limit
  - Proposed scheme included as part of neighbouring consultations
  - ▲ Proposed bus stop improvements, including raised access kerbs and hardstanding areas where needed. Additional proposals, such as bus shelters/ bus stop clearways labelled
  - ▭ Proposed speed table, design height 75mm
  - ▭ Proposed footway buildout
  - \*\*\* Proposed footway/ carriageway maintenance
  - ▬ Proposed no waiting at any time (double yellow lines)
  - ▬ Proposed no waiting Mon - Sat 8am - 6pm (single yellow line)
  - ▬ Proposed limited waiting 1hr Mon - Sat 8am - 6pm no return for 1hr
  - ← Proposed one-way traffic direction

- NOTES:**
1. Pedestrian and cycle crossing points are to be provided or improved, as necessary, with the addition of tactile paving and dropped kerbing as appropriate.
  2. Signing and lining for proposals to be installed in suitable locations where necessary.
  3. Cycle parking to be provided at community facilities.
  4. Existing street lighting columns to be relocated to back of footway where necessary.
  5. Vegetation overhanging the highway boundary to be cut back.
  6. Every effort will be made to avoid affecting existing mature trees but, where unavoidable, two new saplings will be provided as replacement.

**DISCLAIMER:**  
 OTHER RESTRICTIONS NOT SHOWN ON THIS PLAN ARE NOT PART OF THE PROPOSED SCHEME AND THEREFORE WILL NOT CHANGE  
 THIS PLAN IS FOR GRAPHICAL REPRESENTATION ONLY AND DOES NOT FORM PART OF THE FINAL LEGAL ORDER

**NOTE:**  
 CHAPEL STREET AND QUEEN STREET PROPOSALS TO BE READ IN CONJUNCTION WITH DRAWING NUMBER TM4276/1/2014

Traffic management proposals added to drawing, legend updated accordingly	RD	30/10	A
REVISION APPROVED	AMENDMENT	SIGNED/DATE	REV.

# Barwell

**Leicestershire County Council**

ENVIRONMENT AND TRANSPORT DEPARTMENT

PHIL CROSSLAND  
DIRECTOR

**LEICESTERSHIRE HIGHWAYS**

CLIENT: SUSTAINABLE TRAVEL GROUP

TITLE: HINCKLEY ASHBY ROAD TO EARL SHILTON HIGH STREET PROPOSED TRANSPORT IMPROVEMENTS LINK 14 SHEET 2 OF 4

DRAWING NUMBER	SCALE
4225.000/Z1/1/2A	NOT TO SCALE
PREPARED BY: S. TUNNICLIFFE	DATE: 13.10.2014
CHECKED BY: A. SMITH	SIZE: A3
APPROVED BY: M. O'CONNOR	CORR. FILE:
AUTOCAD PROJECT DIR: N:\HINCKLEY PACKAGE AREA ZONE 3\Drawings	
AUTOCAD FILENAME: 4225\4225.000-Z1-1-2a	
COUNTY HALL * GLENFIELD * LEICESTER * LE3 8RJ	
Tel No : 0116 3050001	Direct Dial : 0116 3050001
E-Mail address: steven.tunnicliffe@leics.gov.uk	www.leics.gov.uk

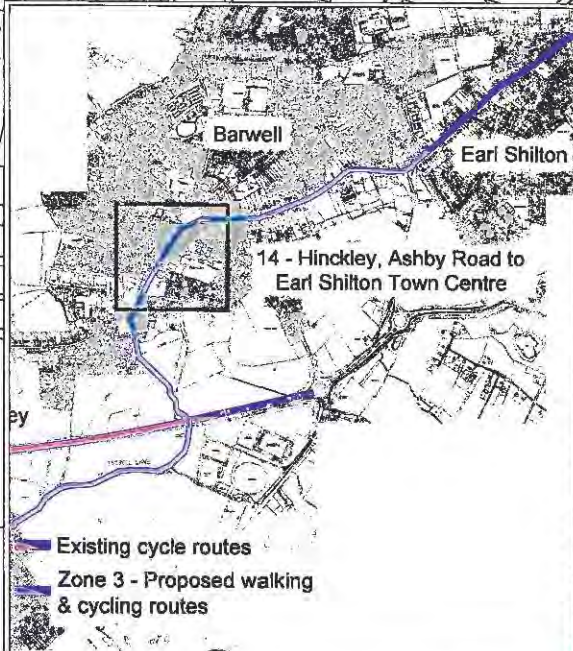

MAPS © (C) Leicestershire County Council  
 This map is reproduced from Ordnance Survey material with the permission of Ordnance Survey on behalf of the Controller of Her Majesty's Stationary Office  
 © Crown copyright. Unauthorised reproduction infringes Crown copyright and may lead to prosecution or civil proceedings. Leicestershire County Council 100019271. Published 2014.

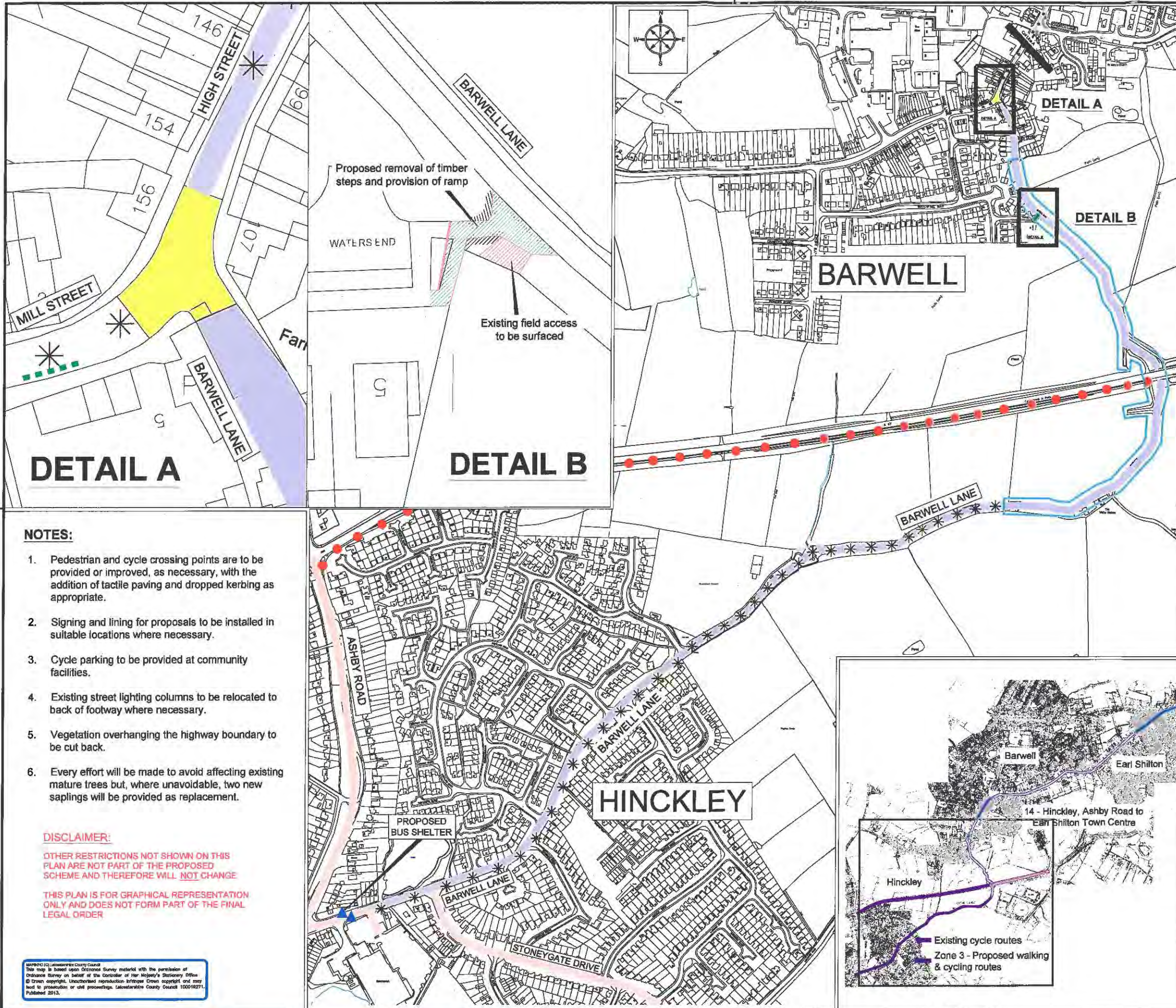

- NOTES:**
- KEY:**
- Proposed on-carriageway section of cycle route, with cycle symbols as needed
  - Proposed scheme included as part of neighbouring consultations
  - Existing cycle route
  - Proposed bus stop improvements, including raised access kerbs and handstanding areas where needed. Additional proposals, such as bus shelters/ bus stop clearways labelled
  - Proposed speed table, design height 75mm
  - Proposed footway/ carriageway maintenance
  - Proposed no waiting at any time (double yellow lines)
  - Proposed prohibition of motor vehicles (except for access)

Traffic management proposals added to drawing, legend updated accordingly		
RD	30/10	A
REVISION APPROVED	AMENDMENT	SIGNED/DATE REV.



ENVIRONMENT AND TRANSPORT DEPARTMENT

PHIL CROSSLAND  
DIRECTOR

ENGINEERING DESIGN

CLIENT: SUSTAINABLE TRAVEL GROUP

TITLE: HINCKLEY  
ASHBY ROAD TO EARL SHILTON  
HIGH STREET  
PROPOSED TRANSPORT IMPROVEMENTS  
LINK 14  
SHEET 1 OF 4

DRAWING NUMBER: 4225.000/Z1/1/1A  
SCALE: NOT TO SCALE

PREPARED BY: S. TUNNICLIFFE DATE: 13.10.2014  
CHECKED BY: A. SMITH SIZE: A3  
APPROVED BY: M. O'CONNOR CORR. FILE:

AUTOCAD PROJECT DIR: N:\HINCKLEY PACKAGE AREA ZONE 3\Drawings  
AUTOCAD FILENAME: 4225\4225.000-Z1-1-1A

COUNTY HALL \* GLENFIELD \* LEICESTER \* LE3 8RJ  
Tel No : 0116 3050001 Direct Dial : 0116 3050001  
E-Mail address: [steven.tunncliffe@leics.gov.uk](mailto:steven.tunncliffe@leics.gov.uk) [www.leics.gov.uk](http://www.leics.gov.uk)

- NOTES:**
1. Pedestrian and cycle crossing points are to be provided or improved, as necessary, with the addition of tactile paving and dropped kerbing as appropriate.
  2. Signing and lining for proposals to be installed in suitable locations where necessary.
  3. Cycle parking to be provided at community facilities.
  4. Existing street lighting columns to be relocated to back of footway where necessary.
  5. Vegetation overhanging the highway boundary to be cut back.
  6. Every effort will be made to avoid affecting existing mature trees but, where unavoidable, two new saplings will be provided as replacement.

**DISCLAIMER:**  
OTHER RESTRICTIONS NOT SHOWN ON THIS PLAN ARE NOT PART OF THE PROPOSED SCHEME AND THEREFORE WILL NOT CHANGE  
THIS PLAN IS FOR GRAPHICAL REPRESENTATION ONLY AND DOES NOT FORM PART OF THE FINAL LEGAL ORDER

MAPPROG 10 Leicestershire County Council  
This map is based upon Ordnance Survey material with the permission of Ordnance Survey on behalf of the Controller of Her Majesty's Stationery Office.  
© Crown copyright. Unauthorised reproduction infringes Crown copyright and may lead to prosecution or civil proceedings. Leicestershire County Council 100018271. Published 2013.

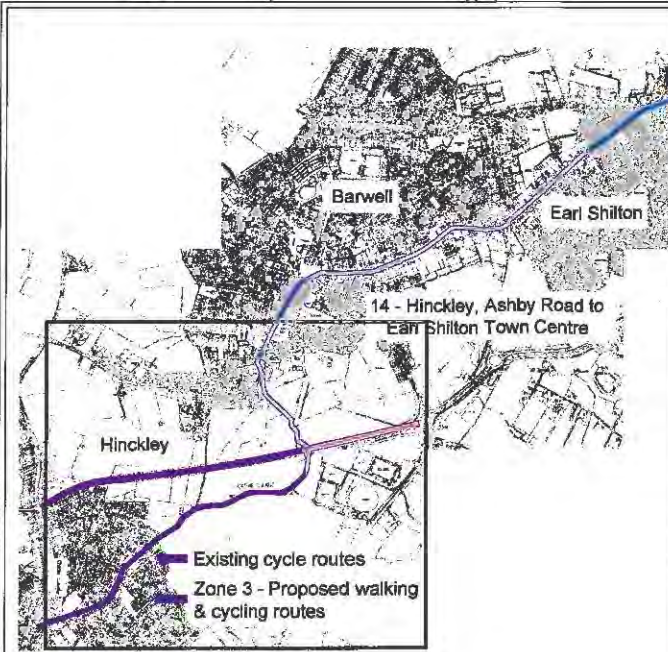
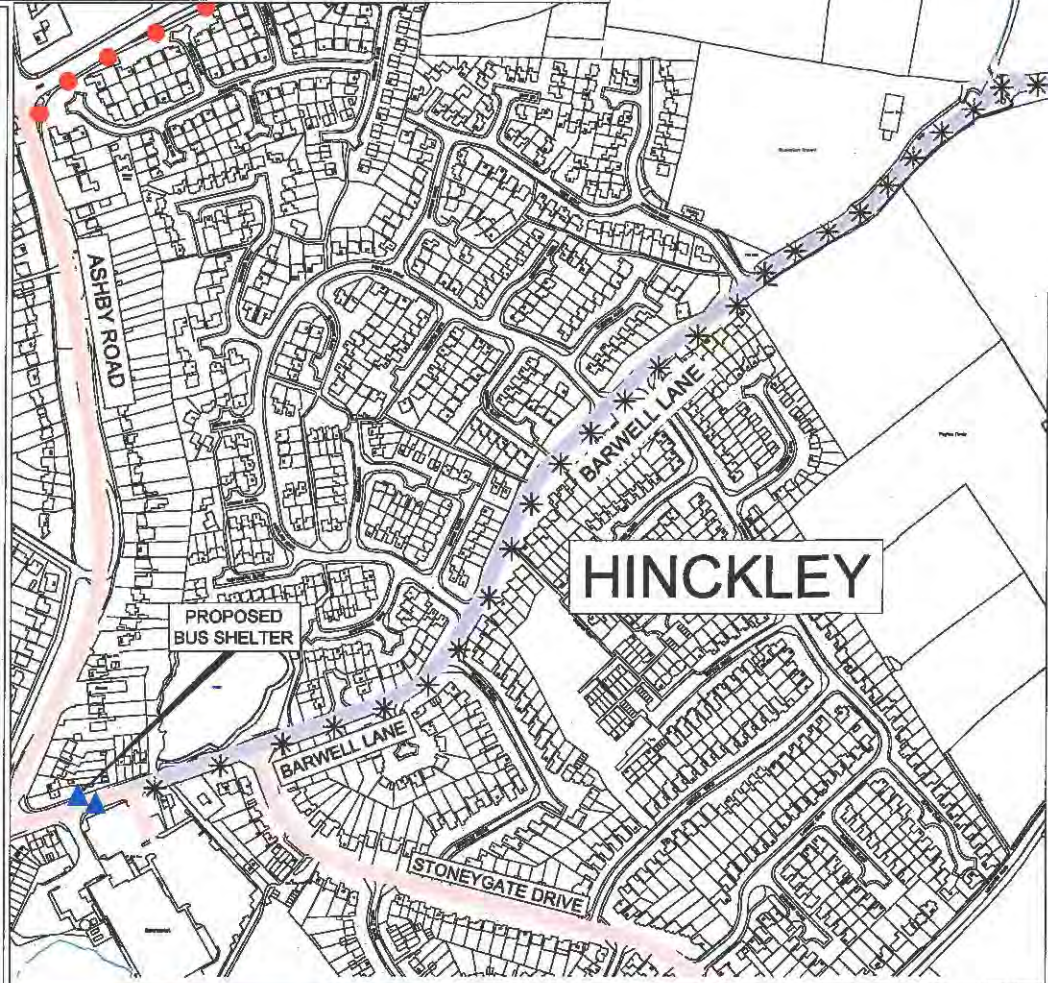

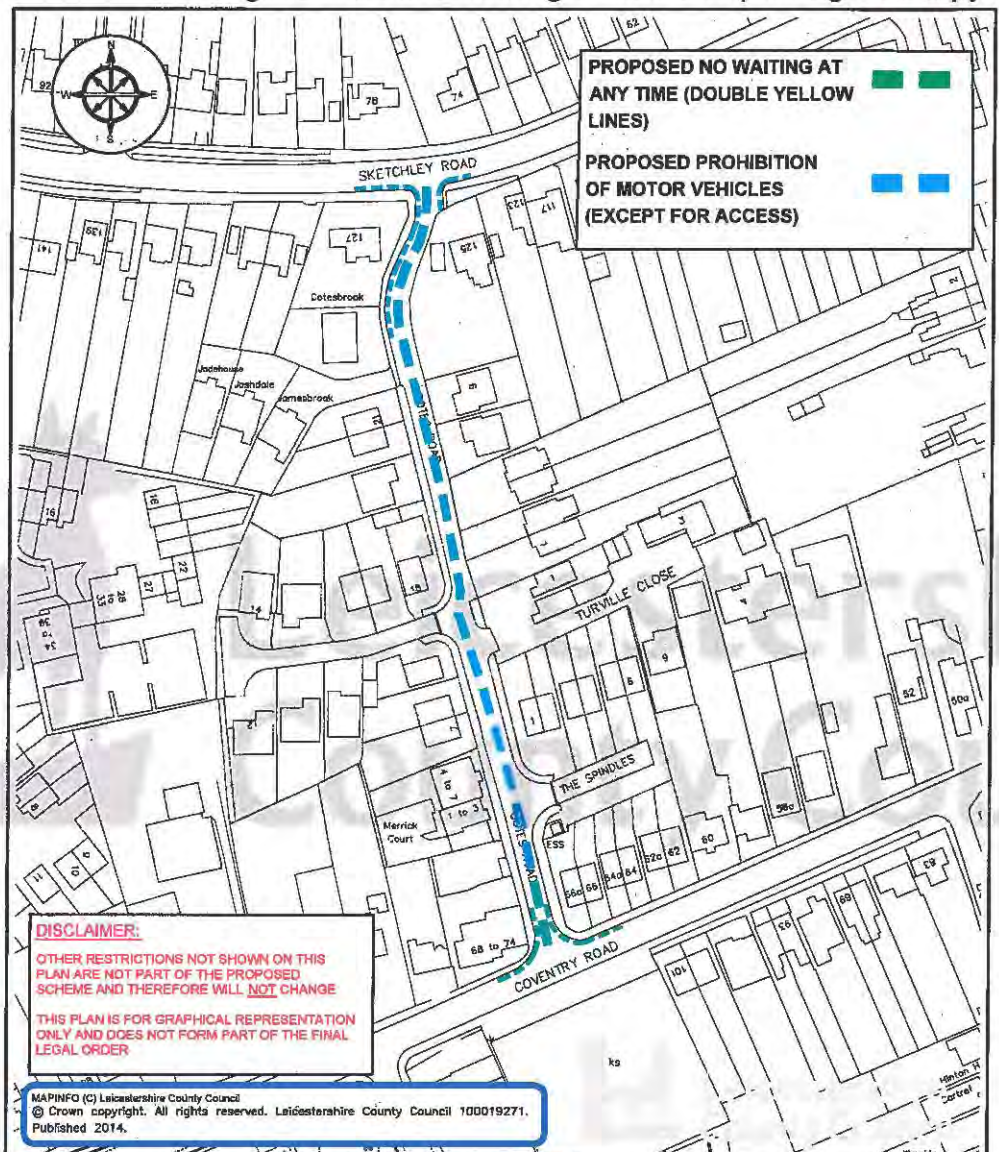

**PROPOSED NO WAITING AT ANY TIME (DOUBLE YELLOW LINES)**

**PROPOSED PROHIBITION OF MOTOR VEHICLES (EXCEPT FOR ACCESS)**

**DISCLAIMER:**  
 OTHER RESTRICTIONS NOT SHOWN ON THIS PLAN ARE NOT PART OF THE PROPOSED SCHEME AND THEREFORE WILL NOT CHANGE  
 THIS PLAN IS FOR GRAPHICAL REPRESENTATION ONLY AND DOES NOT FORM PART OF THE FINAL LEGAL ORDER

MAPPING (C) Leicestershire County Council  
 © Crown copyright. All rights reserved. Leicestershire County Council 100019271.  
 Published 2014.

**Leicestershire County Council**

ENVIRONMENT AND TRANSPORT DEPARTMENT

PHIL CROSSLAND  
DIRECTOR

TRAFFIC & SAFETY GROUP

**TRAFFIC MANAGEMENT**

TITLE:  
HINCKLEY - ZONE 3  
COTES ROAD

DRAWING NUMBER  
TM4273/1/2014

PREPARED BY: R DAVIES  
CHECKED BY: M PALFREYMAN

COUNTY HALL • GLENFIELD • LEICESTER • LE3 8RJ  
Tel: 0115 232322 • 0115 3050001 • Fax: 0115 3050006  
Email address: customer.services@lcc.gov.uk



SCALE  
NTS

DATE: OCT 2014  
SIZE: A4

Website: www.lcc.gov.uk